

# Clara

by Valori Wells

Finished size 54" x 58 1/2"

Rectangles of the large floral prints from Fleurish are cut, arranged, and sewn together into groups. Strips of both the flower box print and the stripe are added between the groups to create an interesting setting for this quilt. Add smaller rectangles of solid fabrics on each of the large floral print blocks. These are either hand or machine appliquéd to the quilt top.



1350 Broadway, 21st Floor  
New York, NY 10018

## Clara – Materials Needed and Cutting Instructions

(all measurements based on accurate cutting, 1/4" seam allowance, and 44" wide strips)

1/2 yard of the flower boxes D1401-940	Cut 4 - 4" x 43 1/2" strips.* *Cut the strips in the middle of the dots that run between the flowers. Cut one strip into 3 - 4" x 8 1/2" rectangles.
7/8 yard of the wildflowers D1400-940	Cut 2 - 12 1/2" x 42" strips. Then cut into 9 - 8 1/2" x 12 1/2" rectangles.
1/3 yard of the stripe D1406-443	Cut 3 - 3 1/2" x 42" strips. Sew these together lengthwise into one long strip. From this cut 1 - 3 1/2" x 31 1/2" strip; cut 2 - 3 1/2" x 24 1/2" strips; and cut 1 - 3 1/2" x 28" strip.
1/4 yard (or 1 fat quarter) each of the jewels D1405-940 green daisy D1403-458 red daisy D1403-135 and purple geranium D1402-307	Cut 2 - 8 1/2" x 12 1/2" rectangles from each of the four fabrics.
1/4 yard (or 1 fat quarter) each of the blue paisley D1404-443 gold paisley D1404-505 blue daisy D1403-255 gold daisy D1403-760 blue dot D1407-220 orange dot D1407-702 and purple dot D1407-940	Cut 1 - 8 1/2" x 12 1/2" rectangle from each of the seven fabrics.
scraps of solids for the appliqués	Cut various rectangles for these. You need a total of 24 rectangles. Suggested sizes for cutting these are: 2 1/2" x 6 1/2"; 3" x 4 1/2"; 3" x 4"; 3" x 5"; 3 1/2" x 8 1/2"; and 4 1/2" x 8."
1/2 yard binding	
3 1/2 yards backing	
60" x 65" quilt batting	

## Clara Sewing Instructions

BEFORE SEWING AND CUTTING, PLEASE READ ALL INSTRUCTIONS TO FAMILIARIZE YOURSELF WITH THEM. ( $1/4''$  seam allowance is included.)

1. Referring to the quilt diagram, sew the blocks together in sections.

**Figure 1.** Press.

2. Arrange the rectangles in a pleasing manner vertically on the blocks. **Figure 2.**

Turn under the edges  $1/4''$  and either machine-appliqué or hand-appliqué these to each of the large blocks.

3. Referring to the quilt diagram, sew a  $3\ 1/2'' \times 24\ 1/2''$  strip of the stripe to the right-hand side of Section 1.

**Figure 3.** Press.

Sew Section 2 to the left-hand side of the stripe. Press.

Sew a  $3\ 1/2'' \times 43\ 1/2''$  strip of the flower box fabric to the top of this unit. Press.

Sew a  $3\ 1/2'' \times 28''$  strip of the stripe to the right-hand side of this unit. Press.

Sew a  $4'' \times 8\ 1/2''$  flower box rectangle to the top of section 3. Press. Sew this unit to the right-hand side of the Section 1/Section 2 unit. Press.

4. Sew a  $4'' \times 8\ 1/2''$  flower box rectangle to the top and bottom of Section 4. Press. Set aside.

Referring to the quilt diagram, sew a  $3\ 1/2'' \times 24\ 1/2''$  strip of the stripe to the right-hand side of Section 5. Press.

Sew Section 6 to the left-hand side of the stripe. Press.

Sew a  $3\ 1/2'' \times 43\ 1/2''$  strip of the flower box fabric to both the top and the bottom of this unit. Press.

5. Sew a  $3\ 1/2'' \times 31\ 1/2''$  strip of the stripe to the right-hand side of Section 4. Press. Sew this unit to the left-hand side of the Section 5/Section 6 unit. Press.

6. Sew the Section 1/Section 2/Section 3 unit to the top of the Section 4/Section 5/Section 6 unit. Press.

7. Layer, quilt, and finish.

Val quilted flowers in the appliquéed rectangles, and echoed the rectangle shapes in the pieced rectangles.

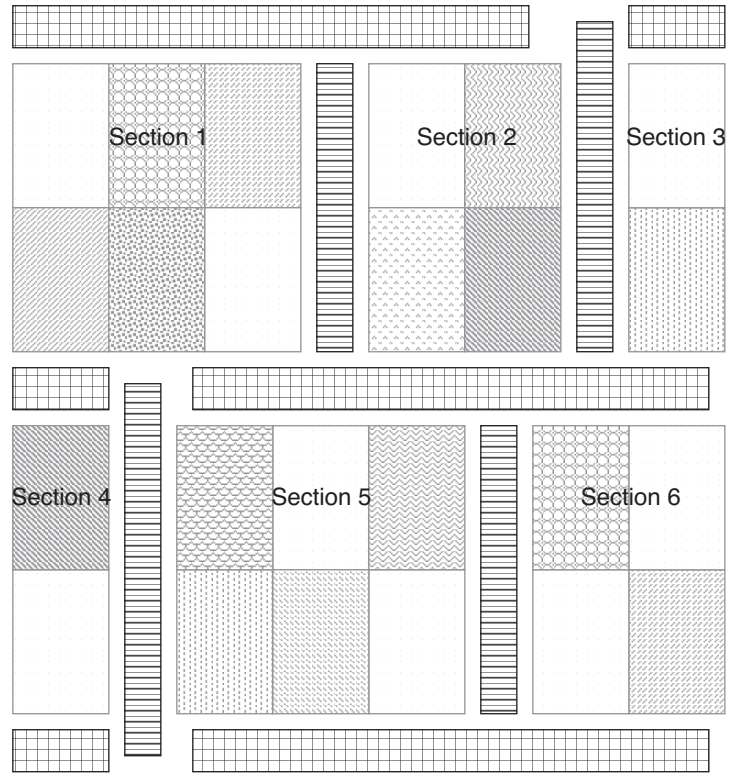

**Figure 1**

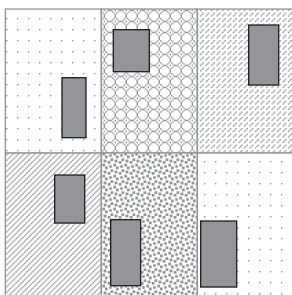

**Figure 2**

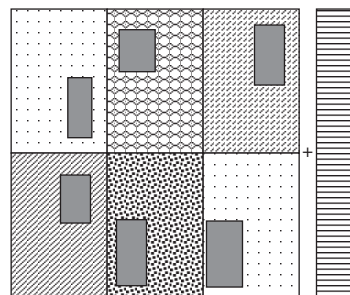

**Figure 3**

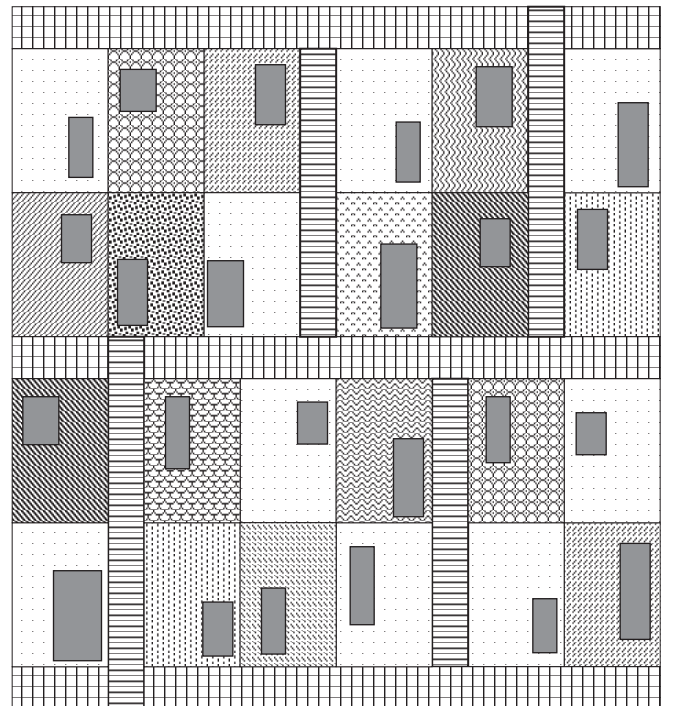

**Clara Quilt Diagram**